

# TRANSMITTER BATTERY

## COMPONENTS

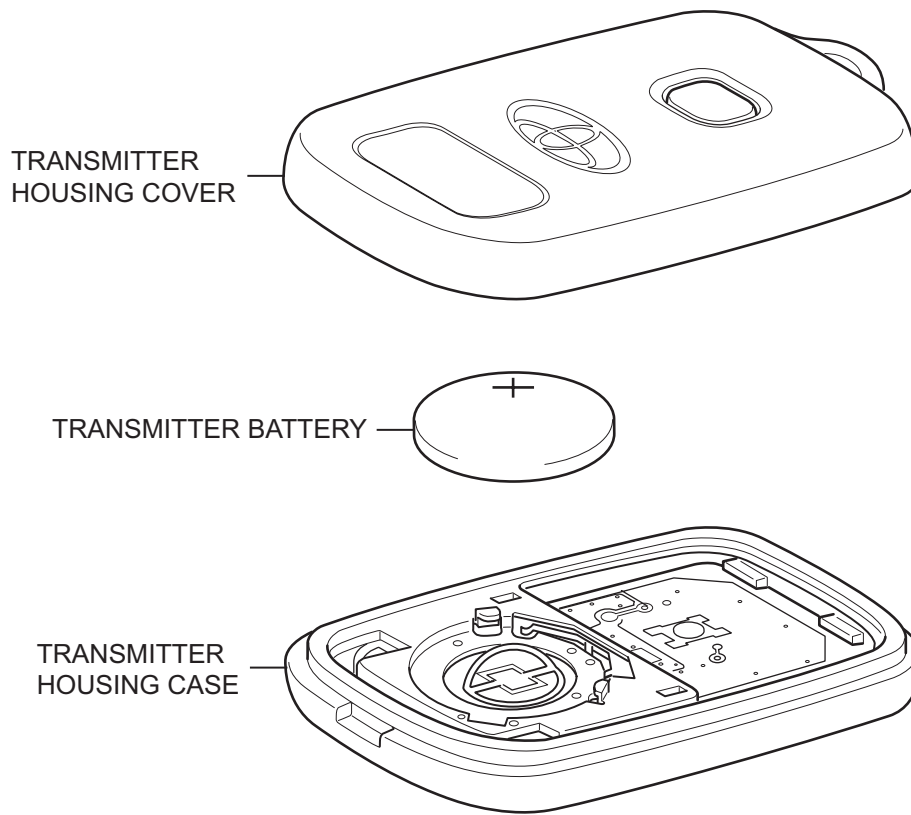

DL

## REMOVAL

### 1. REMOVE TRANSMITTER BATTERY

- (a) Remove the transmitter battery.
- (1) Using a screwdriver with its tip wrapped in protective tape, pry apart the transmitter case.

**NOTICE:**

**Do not use excessive force when prying apart the transmitter case.**

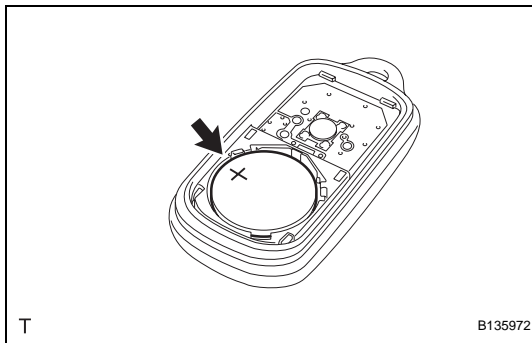
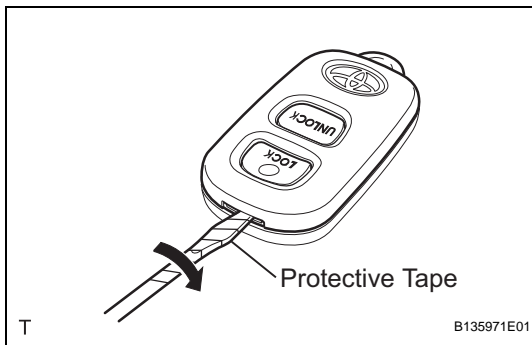

- (2) Remove the battery (lithium battery: CR2016).

**NOTICE:**

- Do not push the terminals with your finger.
- Do not use excessive force when prying up the battery (lithium battery: CR2016) as this may damage the terminals.
- Do not touch the battery with wet hands. Water may cause rust.
- Do not touch or move any components inside the transmitter as this may interfere with its proper operation.

## INSTALLATION

### 1. INSTALL TRANSMITTER BATTERY

- (a) Install the transmitter battery.
- (1) Install the battery (lithium battery: CR2016) with the positive (+) side up, as shown in the illustration.

**NOTICE:**

- Make sure that the positive (+) side and the negative (-) side of the transmitter battery are correctly matched up with the transmitter terminals.
- Do not bend the transmitter battery electrode during insertion.
- Keep the transmitter cover interior free of dust and oil.

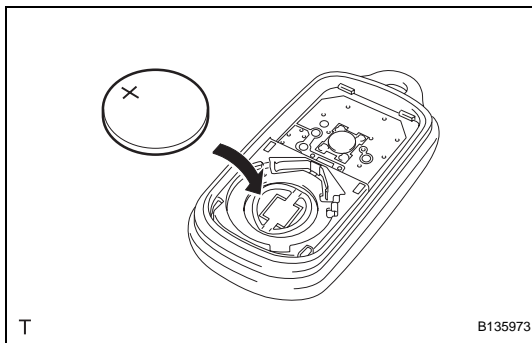

- (2) Install the transmitter case securely.

